

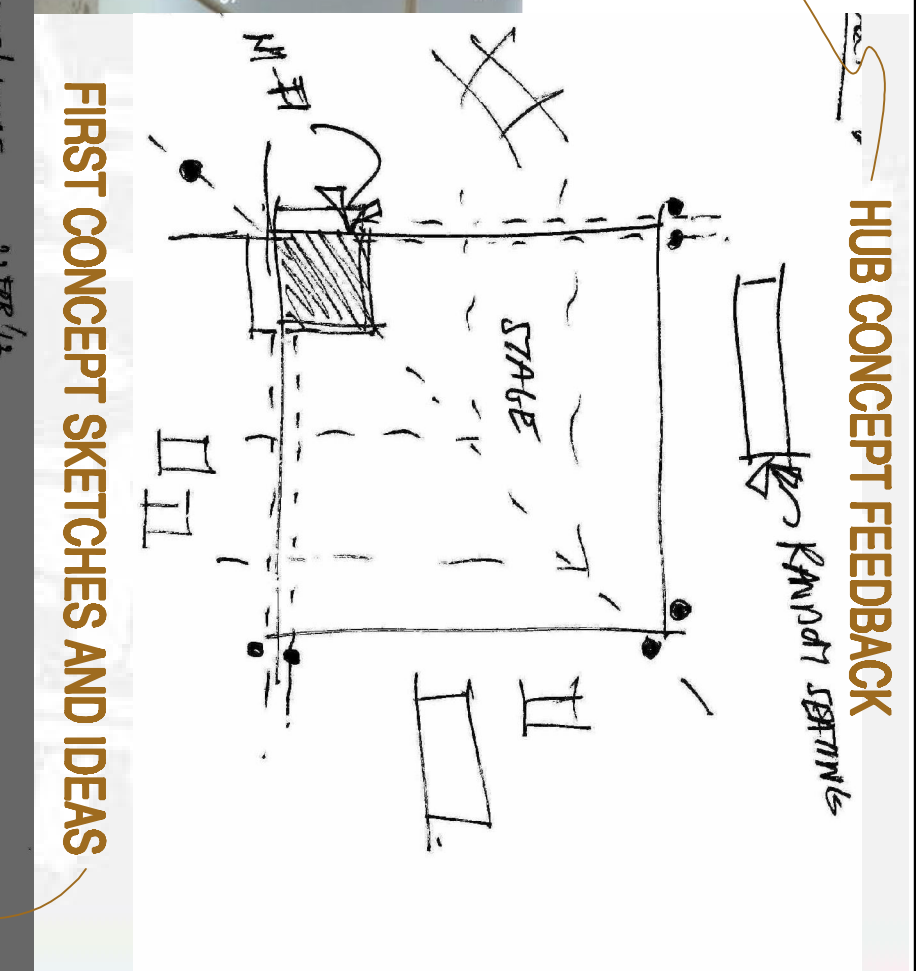

Kululekani Mphumi
Udo Lotter
Mphumi Sibaya

Kululekani Mphumi
 Creative Performance: The Nest – A place of creative nourishment
 Words you used: permeable, ease of access, comfortable occupation
 The idea of permeability links to flexibility. The openness of your structure is appealing. You should think of all planes – roof, floor and wall to make these spaces nourishing and comfortable and also possible flexible in use. Sometimes the spectators to the creative performance might sit on a big floor plane and sometimes on a small one. In other words there does not have to be a set “stage” – that could move as the need requires.
A permeable space that encourages flexible use for creative performance



HUB CONCEPT FEEDBACK

KANDI SKETCHES

FIRST CONCEPT SKETCHES AND IDEAS

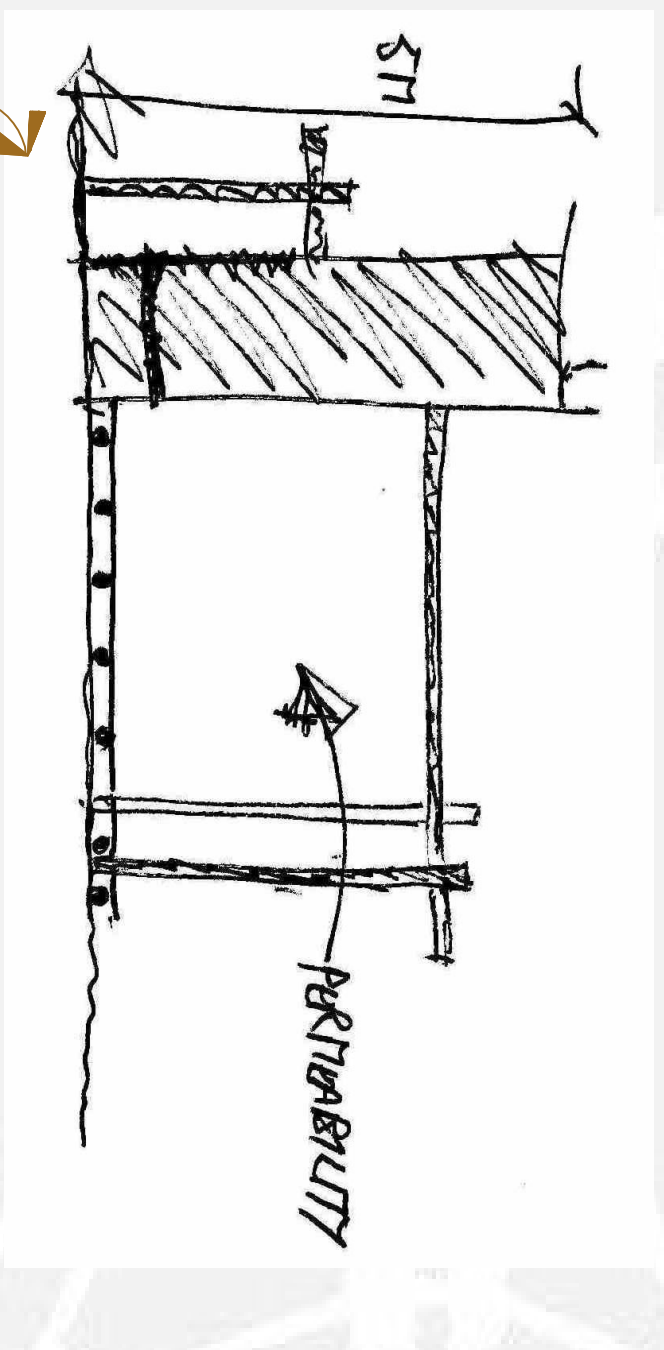

ROUGH CONCEPT MODEL

BRIEF / THOUGHTS / IDEAS 22 FEB '18

KANDI SKETCHES

FUNCTION:

- NOURISH (COMMUNITY)
- PERFORMANCES
- GRAFTS (MARKET)
- RAYS
- HARBOR, STADIS
- "ACT" EXHIBITS

TECHNOLOGY:

- GRID 1M X 5M HIGH
- GANTRIES & TRAVEL RAY
- FLEXIBLE STRUCTURE
- SIMPLE ASSEMBLY
- SHARPE STRUCTURE

PERMEABILITY

COMMUNITY HUB - "A PERMEABLE SPACE THAT ENCOURAGES FLEXIBLE USE FOR CREATIVE PERFORMANCE"

UDO LOTTER



196051665